

Fukushima March 11 Memorial Park

Business Hours

Administration Office

Open: 9:00—17:00
 Closed: Tuesdays
 (when a national holiday or the 11th of the month falls on a Tuesday, the office is open on Tuesday and closed the next day)
 December 29 to January 3

National Memorial Hall

Open: 9:00—17:00
 (no entry after 16:30)
 Closed: Tuesdays
 (when a national holiday or the 11th of the month falls on a Tuesday, the memorial hall is open on Tuesday and closed the next day)
 December 29 to January 3
 Admission: Free



Published by:
 Fukushima Prefecture
 and
 Tohoku National Government
 Park Office
 (Tohoku Regional Development
 Bureau of the Ministry of Land,
 Infrastructure, Transport and
 Tourism)

Location

Fukushima March 11 Memorial Park
 Futaba and Namie Towns,
 Futaba-gun, Fukushima Prefecture
 Japan

National Memorial Hall

Futaba and Namie Towns,
 Futaba-gun, Fukushima Prefecture
 Japan

Contact

About the park

16-1 Nakano Aza Takada,
 Futaba-machi, Futaba-gun,
 Fukushima Prefecture 979-1401 Japan
 TEL. +81 240 23 6218
 FAX. +81 240 23 6219

About the memorial hall

50 Oaza Nakahama Aza Nishikawara,
 Namie-machi, Futaba-gun,
 Fukushima Prefecture 979-1523 Japan
 TEL.+81 240 23 5415
 FAX.+81 240 23 5416

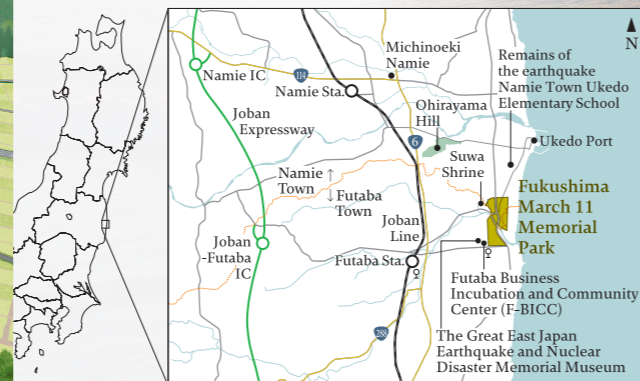
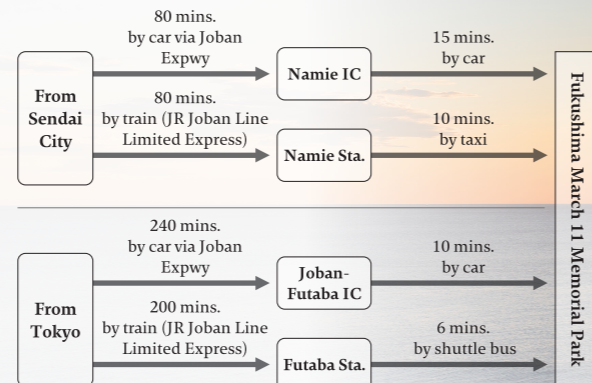

Fukushima March 11 Memorial Park

Mourning... A Journey through Remembering, Recovering, and Rejuvenating

The Fukushima March 11 Memorial Park was established by Fukushima Prefecture and the National Government of Japan as a place to mourn and pray for the victims of the Great East Japan Earthquake of March 11, 2011.

At 2:46 p.m. on March 11, 2011, the strongest earthquake ever recorded in the country struck off the northeastern coast of Japan. It was followed by a devastating tsunami. The coastal areas of Iwate, Miyagi, and Fukushima prefectures were among the hardest hit. In Fukushima, the disaster was compounded by severe damage to nuclear power reactors. The recovery from this crisis continues even now. The Fukushima March 11 Memorial Park was created as a place to mourn and pray for the victims, to preserve the memories and lessons of the disaster, and to communicate the story of ongoing revitalization efforts to the world. It stands as both a site of remembrance and a symbol of determination for the future.



Park Zones

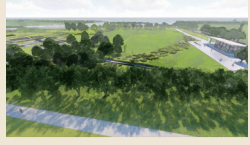

Multipurpose Field

A three-hectare turf field used for various events and activities.



Nakano Settlement

The remains of a settlement that was evacuated after the earthquake, tsunami, and resulting nuclear power reactor accident.



Cherry Tree Hill

This area is home to a plantation of cherry trees, including the endemic Oshima cherry (*Cerasus speciosa*).



Dangoyama Knoll

This small, rounded hill was a local landmark known as Dangoyama (literally, “rice dumpling mountain”).

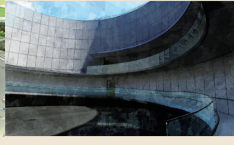

National Memorial Hall

The top of the memorial hall provides panoramic views, and signage indicates the direction of the earthquake's epicenter. Nestled inside the base of the hall is a



Morotake Settlement

A new rural landscape is being fostered here, remembering the former settlement through earth mounds that mark where houses once stood.



Waterside Area

The earthquake caused the land here to subside, forming a wetland. This area has been left untouched to observe how the environment changes naturally over time.



Facilities in the park

Visitor facilities



Administration Office
The park administration office provides information and a resting space for visitors.

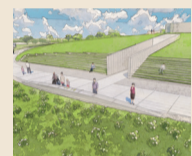

Altar for Flower Offerings
Halfway up the path to the National Memorial Hall an altar is placed with a view of the sea, at which people may offer flowers.

Spots of interest



Masuda Bridge
From this bridge, itself a survivor of the disaster, the remains of the Nakano settlement are visible.



Severely Damaged Road Surface
The twisted and cracked road surface testifies to the force of the disaster.

Facilities outside the park

Visitor facilities



The Great East Japan Earthquake and Nuclear Disaster Memorial Museum
The museum provides information about the disaster and recovery efforts.



Futaba Business Incubation and Community Center (F-BICC)
The community center houses meeting rooms, a food court, and shops.

Spots of interest



Marine House Futaba
Although the building was nearly destroyed by the tsunami, it saved lives when evacuees took refuge on its third floor. (Off-limits.)



Suwa Shrine
On the night of the earthquake, local residents sheltered overnight within the shrine's compound.



Remains of the earthquake Namie Town Ukedo Elementary School
The damaged buildings of the elementary school are used as a visitor center.